

## Set Screw Type - Normal Duty

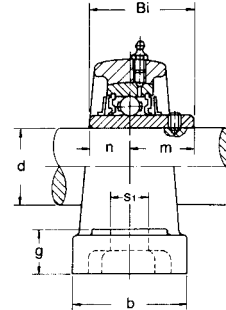
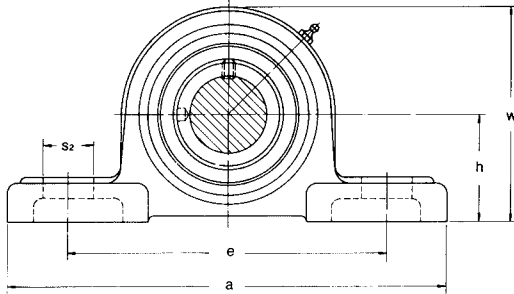

Unit No.	Shaft Dia		Dimensions (in.) (mm)											Bolt Used		Bearing No.	Housing No.	Weight		
	d		h	a	e	b	s <sub>2</sub>	s <sub>1</sub>	g	w	Bi	n	m					kg	lbs	
	(in.)	(mm)												(mm)	(in.)					
UCP 201		12																		
201-8	1/2	12	1-3/16	5	3-3/4	1-1/2	3/4	1/2	15/32	2-3/8	1.2205	0.5000	0.7205							
202		15	30.2	127	95	38	19	13	12	60	31.0	12.7	18.3	10	3/8	UC 201				
202-10	5/8	15														201-8				
203		17														202	P 203	0.65	1.43	
																202-10				
																203				
UCP 204-12	3/4		1-5/16	5	3-3/4	1-1/2	3/4	1/2	1/2	2-17/32	1.2205	0.5000	0.7205			UC 204-12				
204		20	33.3	127	95	38	19	13	13	63	31.0	12.7	18.3	10	3/8	204	P 204	0.65	1.43	
UCP 205-14	7/8															UC 205-14				
205-15	15/16		1-7/16	5-1/2	4-1/8	1-1/2	3/4	1/2	1/2	2-25/31	1.3386	0.5630	0.7756			205-15				
205		25	36.5	140	105	38	19	13	13	70	34.0	14.3	19.7	10	3/8	205	P 205	0.79	1.74	
205-16	1															205-16				
UCP 206-18	1-1/8		1-11/16	6-1/2	4-3/4	1-7/8	13/16	21/32	19/32	3-5/16	1.5000	0.6260	0.8740			UC 206-18				
206		30	42.9	165	121	48	21	17	15	83	38.1	15.9	22.2	14	1/2	206	P 206	1.30	2.86	
206-19	1-3/16															206-19				
UCP 207-20	1-1/4															UC 207-20				
207-21	1-5/16															207-21				
207-22	1-3/8		1-7/8	6-9/16	5	1-7/8	13/16	21/32	5/8	3-21/32	1.6890	0.6890	1.000	14	1/2	207-22	P 207	1.60	3.52	
207		35	47.6	167	127	48	21	17	16	92	42.9	17.5	25.4			207				
207-23	1-7/16															207-23				
UCP 208-24	1-1/2		1-15/16	7-1/4	5-13/32	2-1/8	13/16	21/32	21/32	3-27/32	1.9370	0.7480	1.1890			UC 208-24				
208-25	1-9/16		49.2	184	137	54	21	17	17	98	49.2	19.0	30.2	14	1/2	208-25	P 208	2.00	4.40	
208		40														208				
UCP 209-26	1-5/8															UC 209-26				
209-27	1-11/16		2-1/8	7-15/32	5-3/4	2-1/8	13/16	21/32	21/32	4-3/16	1.9370	0.7480	1.1890			209-27				
209-28	1-3/4		54.0	190	146	54	21	17	17	106	49.2	19.0	30.2	14	1/2	209-28	P 209	2.30	5.06	
209		45														209				
UCP 210-30	1-7/8		2-1/4	8-1/8	6-1/4	2-3/8	7/8	25/32	3/4	4-7/16	2.0315	0.7480	1.2835			UC 210-30				
210-31	1-15/16		57.2	206	159	60	22	20	19	112	51.6	19.0	32.6	16	5/8	210-31	P 210	2.70	5.94	
210		50														210				
UCP 211-32	2															UC 211-32				
211-34	2-1/8		2-1/2	8-5/8	6-25/32	2-3/8	7/8	25/32	3/4	4-29/32	2.1890	0.8740	1.3150			211-34				
211		55	63.5	219	171	60	22	20	19	125	55.6	22.2	33.4	16	5/8	211	P 211	3.30	7.26	
211-35	2-3/16															211-35				
UCP 212-36	2-1/4															UC 212-36				
212		60	2-3/4	9-1/2	7-1/4	2-3/4	1	25/32	7/8	5-7/16	2.5630	1.000	1.5630			212				
212-38	2-3/8		69.8	241	184	70	25	20	22	137	65.1	25.4	39.7	16	5/8	212-38	P 212	4.70	10.32	
212-39	2-7/16															212-39				
UCP 213-40	2-1/2		3	10-7/16	8	2-3/4	1-3/16	1	1	5-29/32	2.5630	1.0000	1.5630			UC 213-40				
213		65	76.2	265	203	70	30	25	25	150	65.1	25.4	39.7	20	3/4	213	P 213	5.60	12.32	

Dimensions listed is for reference only